



VULCANIZING PRESSES



## SPOT PRESS (SP)

VULCANIZING REPAIR PRESS

The ALMEX **Spot Repair Press** is a superior vulcanizing press for heavy weight rubber belt maintenance.

### FEATURES:

- Signature Shaw Almex "Pressure Bag" uniform pressure system
- Custom "Extruded Plank" fast cooling system within platens
- Durable silicon heating element
- Lightweight and portable structure

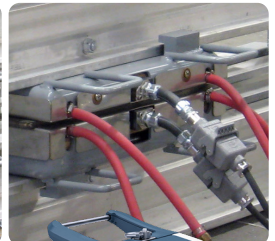
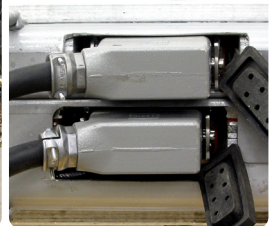
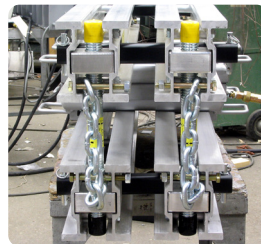

scanme

### AVAILABLE ACCESSORIES:

- T6 Series Control Boxes
- Cooling and Pressure Tanks





# SPOT PRESS (SP) Repair Press

PRODUCT SPECIFICATIONS:

## PLATENS

- Utilized innovative Almex Flexible platen constructed from extruded plank, silicone heating element and durable composite insulation. Each platen contours to the belt's irregularities, ensuring uniform results
- Maximum temperature 163 °C (325 °F)
- Available Platen Sizes: 300 mm x 300 mm (12"x12"), 500 mm x 500 mm (20" x 20")

## FRAME

- Welded aluminum C-Frame with handle for easy, one man handling
- Two sizes are available for use on belt widths up to 1500 mm (60") and 2000 mm (78"). Complete with platen carrying case

## CONTROL BOX

### SUITABLE CONTROLS:

- T2: Remote, maximum 40 amps total) for 230 Volt single phase operation
- T6: Remote, maximum 30 amps total for three phase operation
- T2 and T6 panels feature dual temperature control and indication systems
- An optional timer is available.

## PRESSURE, COOLING

### SUITABLE PUMP:

- HP25MAX
- HPP-204
- Pressure available in 7 kg/cm<sup>2</sup>, 100 psi and 14 kg/cm<sup>2</sup>, 200 psi
- For pressure greater than 100 psi a fluid pressure pump and reservoir Model HPP20-4 or HP25MAX are available.



# SPOT PRESS (SP) Repair Press

PRODUCT SPECIFICATIONS:

## Spot Repair 12" Platen

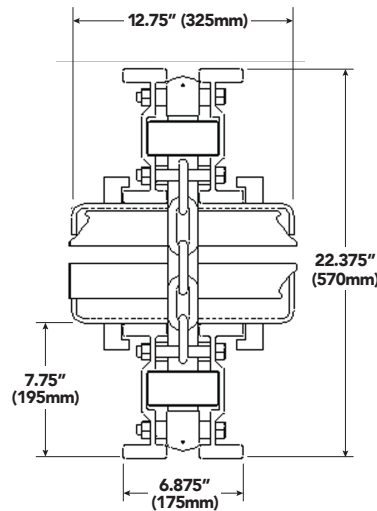

SPANNER BAR WITH BOLT/NUT ASSY.	MODEL SP		MODEL SPHD	
	TYPE EA	TYPE EAX	TYPE EA	TYPE EAX
	in	mm	in	mm
A	7	175	7	175
B	7.75	195	10	265
C	22	570	27.5	700

SP Max.operating pressure 100 PSI (7kg/cm<sup>2</sup>), Maxiium temperature 325° F (163° C)

MODEL	MAX BELT WIDTH		EA BAR LENGTH		COMPONENT WEIGHTS								PWR		
	IN	MM	IN	MM	EA BAR WEIGHT		EA BOLT/NUT ASSY. WEIGHT		UPPER PLATEN ASSY.		LOWER PLATEN ASSY.			TOTAL WEIGHT	
					LBS	KG	LBS	KG	LBS	KG	LBS	KG	LBS	KG	KW
SP12-42	42	1000	51	1295	63	29	18	8	34	15	50	23	260	118	0.9
SP12-48	48	1200	57	1445	71	32	18	8	34	15	50	23	275	125	0.9
SP12-72	72	1800	81	2055	100	46	18	8	34	15	50	23	335	152	0.9
SP12-84	84	2100	93	2360	115	52	18	8	34	15	50	23	365	165	0.9

Specifications are approximate and subject to change without notice.

## Spot Repair 20" Platen

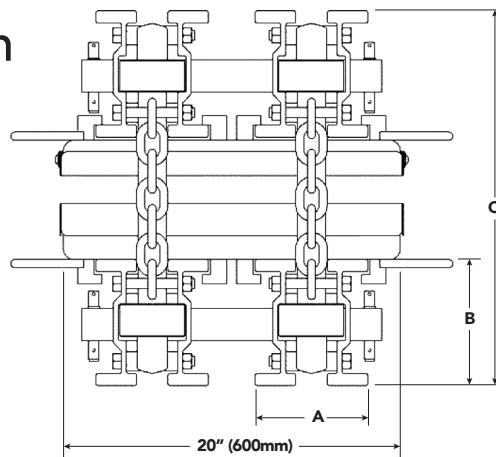

SPANNER BAR WITH BOLT/NUT ASSY.	MODEL SP		MODEL SPHD	
	TYPE EA	TYPE EAX	TYPE EA	TYPE EAX
	in	mm	in	mm
A	7	175	7	175
B	7.75	195	10	265
C	22	570	27.5	700

SP Max.operating pressure 100 PSI (7kg/cm<sup>2</sup>), SPHD Max.operating pressure 200 PSI (14kg/cm<sup>2</sup>)

MODEL	MAX BELT WIDTH		BAR LENGTH		COMPONENT WEIGHTS								PWR		
	IN	MM	IN	MM	BAR WEIGHT		BOLT/NUT ASSY. WEIGHT		UPPER PLATEN ASSY.		LOWER PLATEN ASSY.			TOTAL WEIGHT	
					LBS	KG	LBS	KG	LBS	KG	LBS	KG	LBS	KG	KW
SP20-48	48	1200	57	1445	71	32	18	8	83	38	105	48	575	260	2.6
SP20-60	48	1500	69	1750	86	39	18	8	83	38	105	48	635	285	2.6
SP20-72	72	1800	81	2055	123	45	18	8	83	38	105	48	635	313	2.6
SP20-84	84	2100	93	2360	141	52	18	8	83	38	105	48	635	340	2.6
SP20-96	96	2400	105	2665	160	59	18	8	83	38	105	48	635	365	2.6
SPHD20-72	72	1800	81	2055	123	56	20	8	83	38	110	50	795	360	2.6
SPHD20-84	84	2100	93	2360	141	64	20	8	83	38	110	50	865	390	2.6
SPHD20-96	96	2400	105	2665	160	73	20	8	83	38	110	50	945	430	2.6

Specifications are approximate and subject to change without notice.